

# -HBS 100- Fundamentplan

Zum Einbetonieren:

Typbreite	A	B	C	D
3000	3.020	3.250	65	3.122
3500	3.520	3.750	65	3.622
4000	4.020	4.250	65	4.122
4200	4.220	4.450	65	4.322
4500	4.520	4.750	65	4.622
5000	5.020	5.250	65	5.122
6000	6.020	6.250	65	6.122
7000	7.020	7.250	65	7.122
8000	8.020	8.250	65	8.122
9000	9.020	9.250	65	9.122
10000	10.020	10.250	65	10.122

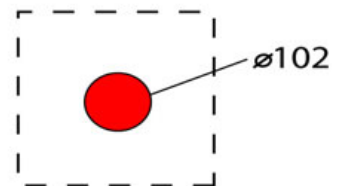
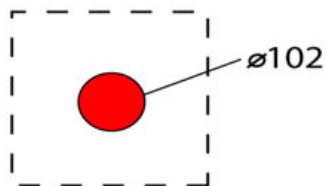
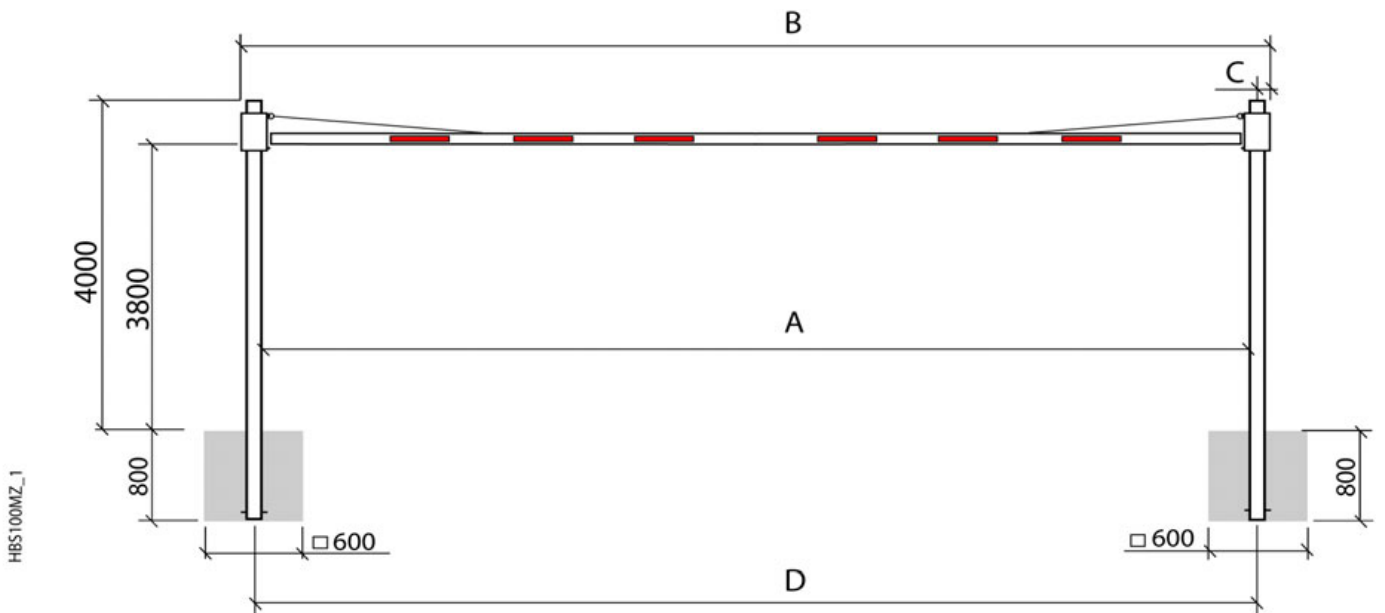
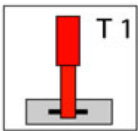

# -HBS 100- Fundamentplan

Zum Aufschrauben:

Typbreite	A	B	C	D
3000	2.872	3.372	125	3.122
3500	3.372	3.872	125	3.622
4000	3.872	4.372	125	4.122
4200	4.072	4.572	125	4.322
4500	4.372	4.872	125	4.622
5000	4.872	5.372	125	5.122
6000	5.872	6.372	125	6.122
7000	6.872	7.372	125	7.122
8000	7.872	8.372	125	8.122
9000	8.872	9.372	125	9.122
10000	9.872	10.372	125	10.122

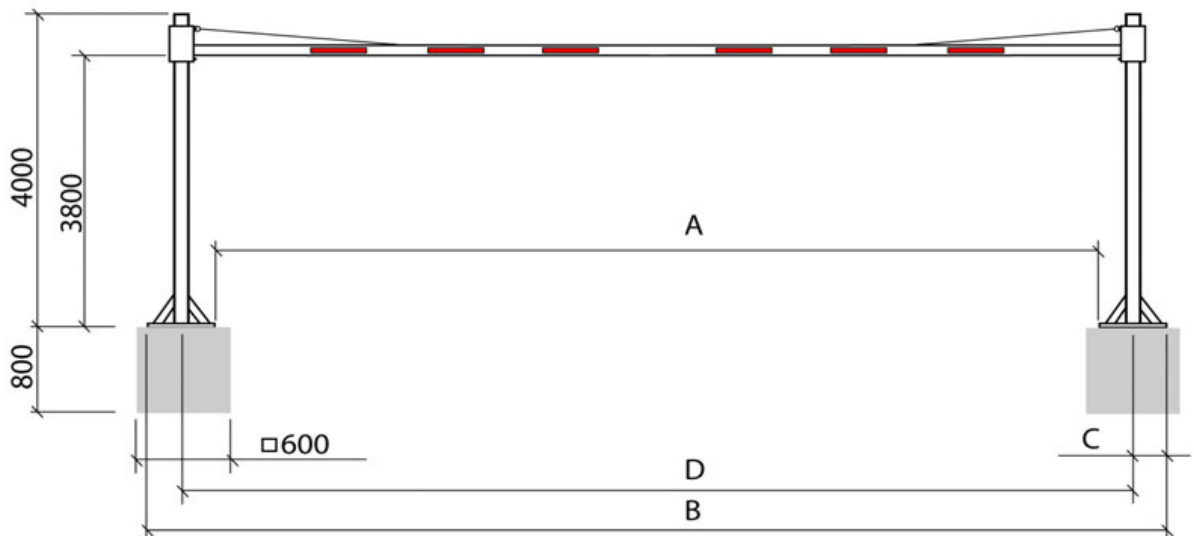
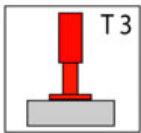

HBS100MZ\_3

